

## WIRING

- Note.
1. The wiring for the safety switch contacts **MUST** be used.
  2. Choose the wiring diagram from those below which matches that of the appliance. If in doubt contact the appliance manufacturer.
  3. Wiring diagram provided depict the additional wiring needed for the inclusion of the condensate pump. This scheme may be incorporated into the existing wiring centre junction box, fused spur etc. incorporated in the heating system as appropriate.

### SAFETY SWITCH CONTACT NC/NO

To use the safety switch contact as potential-free normally open contact, the following change must be done:

- Unscrew the cover fixing-screw, push in the clips and remove the cover.
- Pull off the flat plug socket from the middle contact of the safety switch and plug it on the top contact.
- Replace the cover and tighten the fixing-screw.

NC

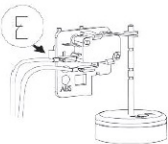

NO

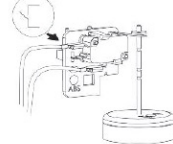

### GENERAL SAFETY SWITCH WIRING DIAGRAM

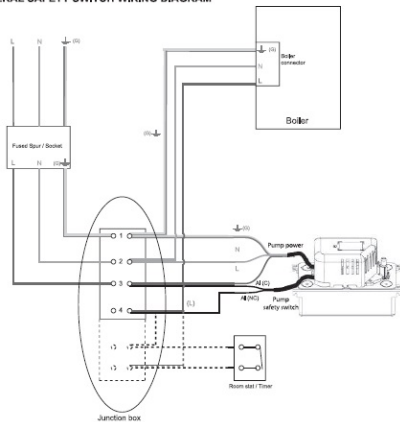

## Standard Pump Wiring

Neutral, earth and switching cables have been omitted for clarity

